

**This electronic collection of documents is provided
for the convenience of the user
and is Not a Certified Document –**

**The documents contained herein were originally issued
and sealed by the individuals whose names and license
numbers appear on each page, on the dates appearing
with their signature on that page.**

**This file or an individual page
shall not be considered a certified document.**

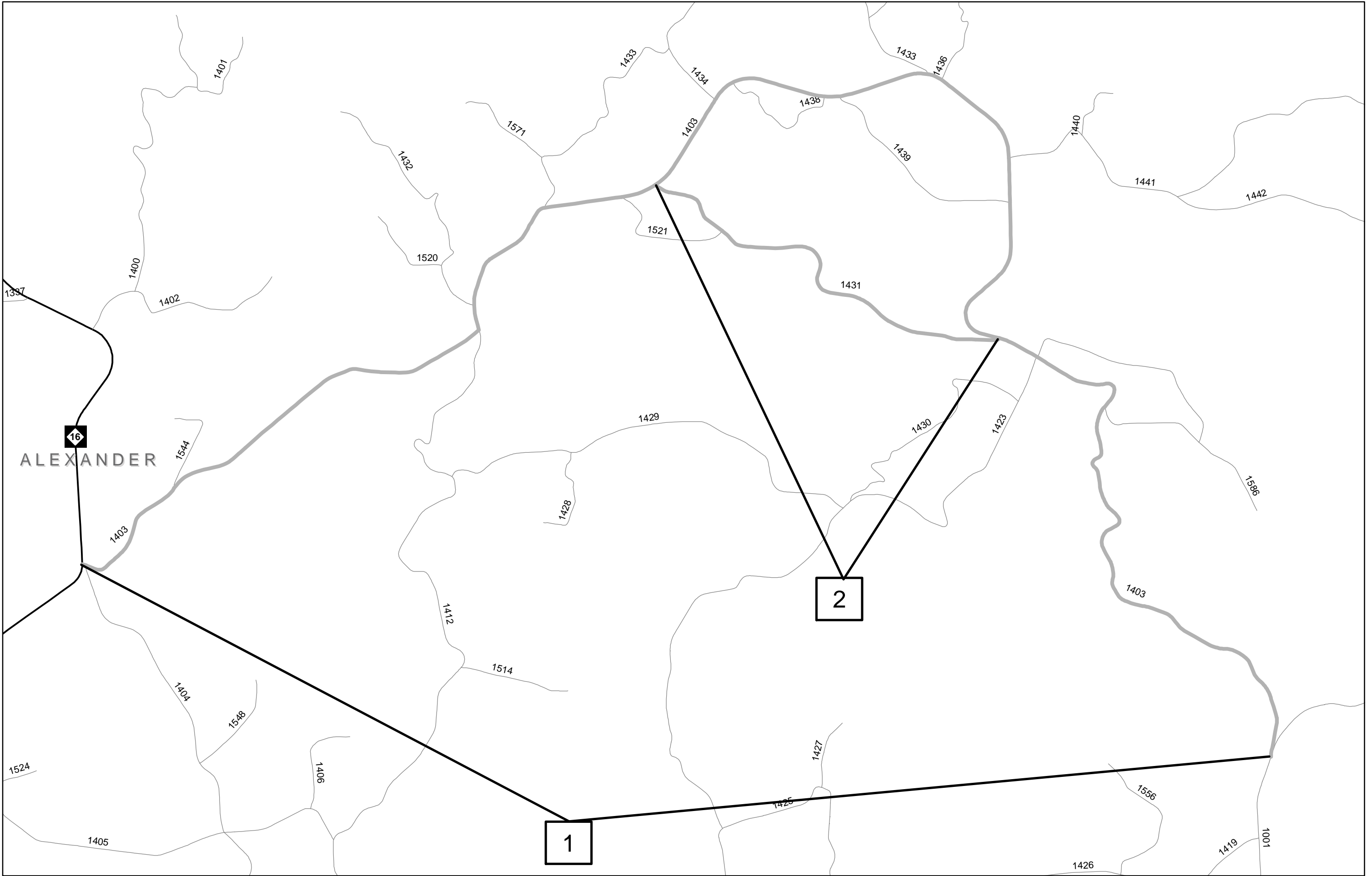

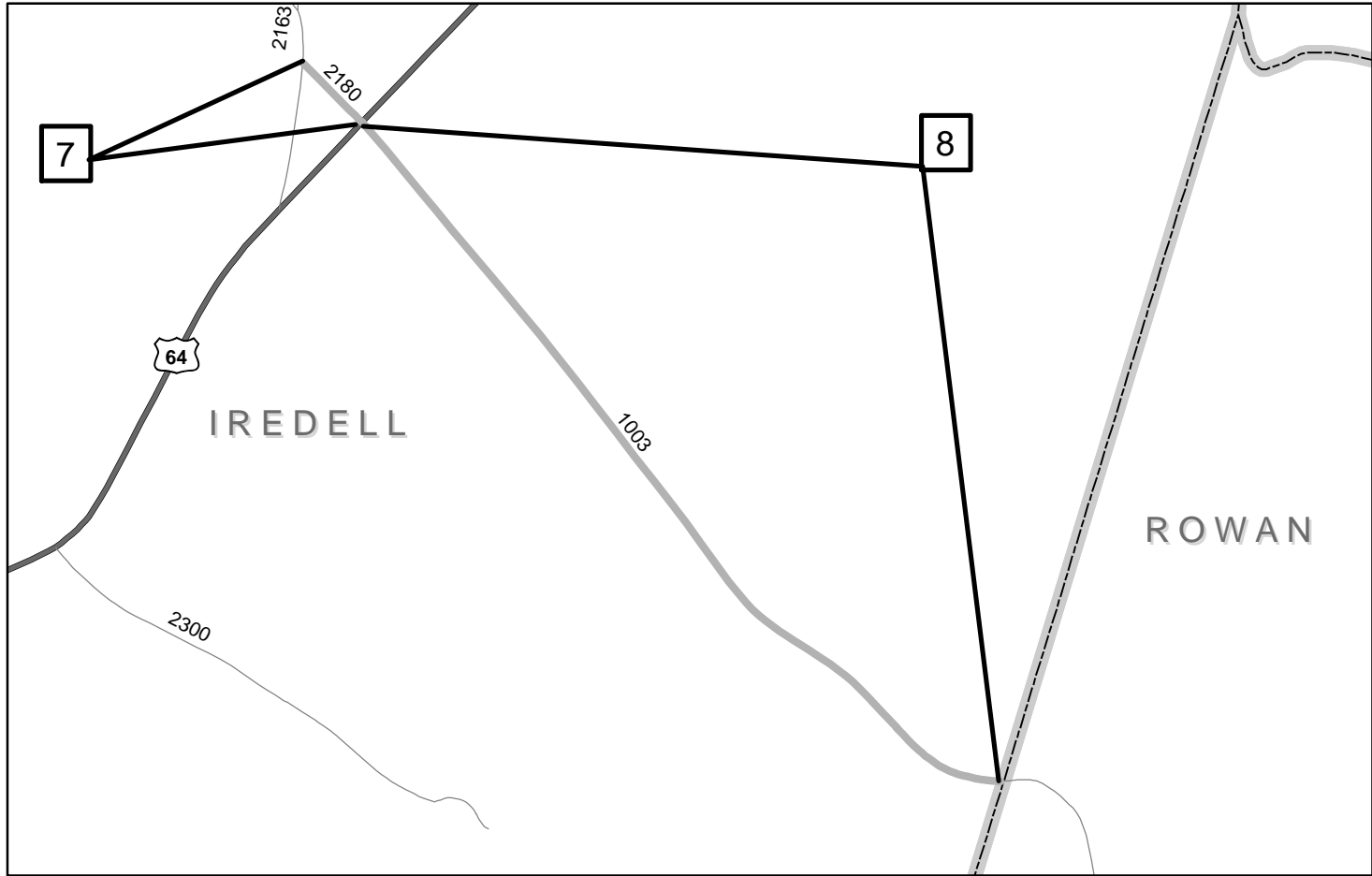
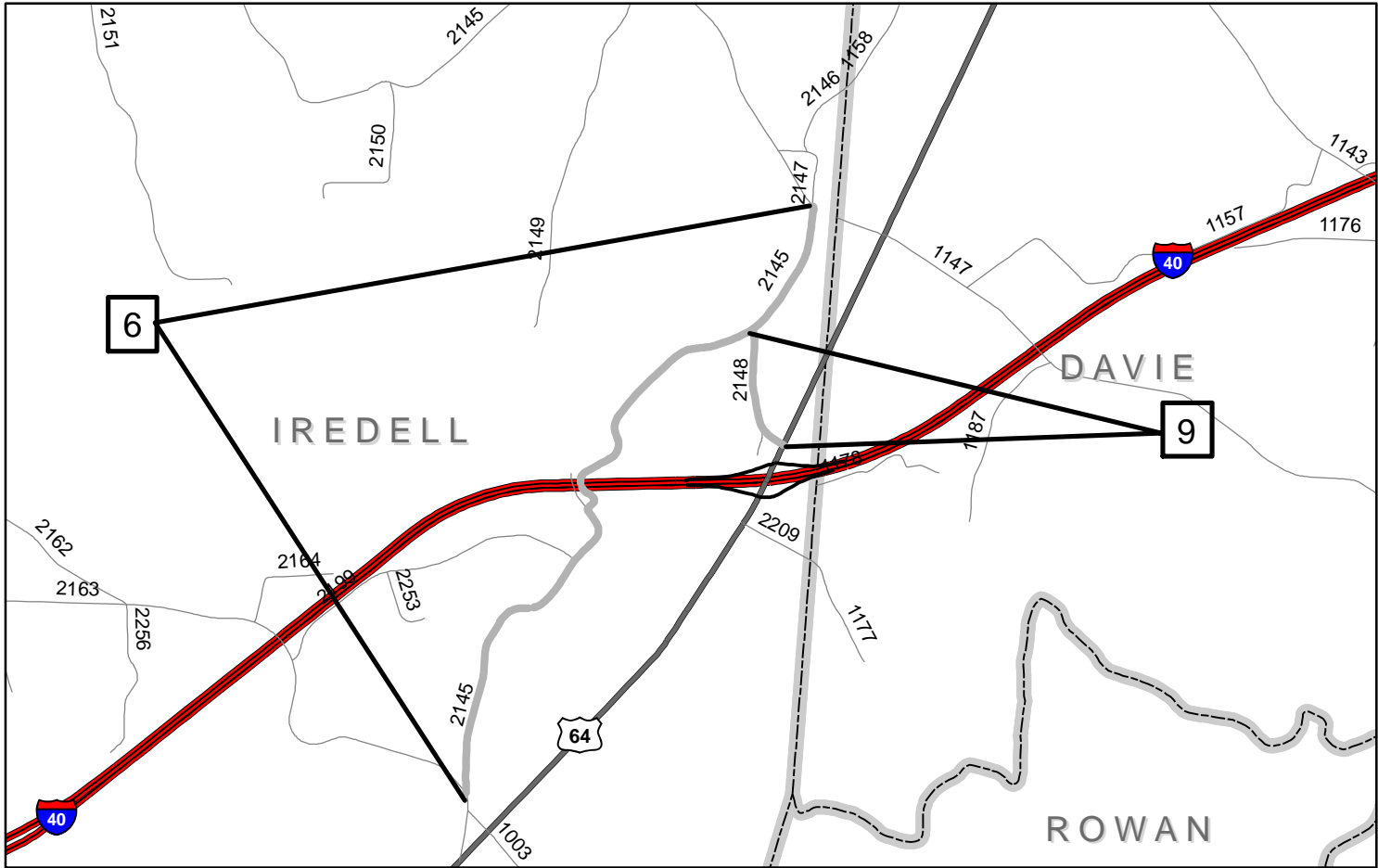
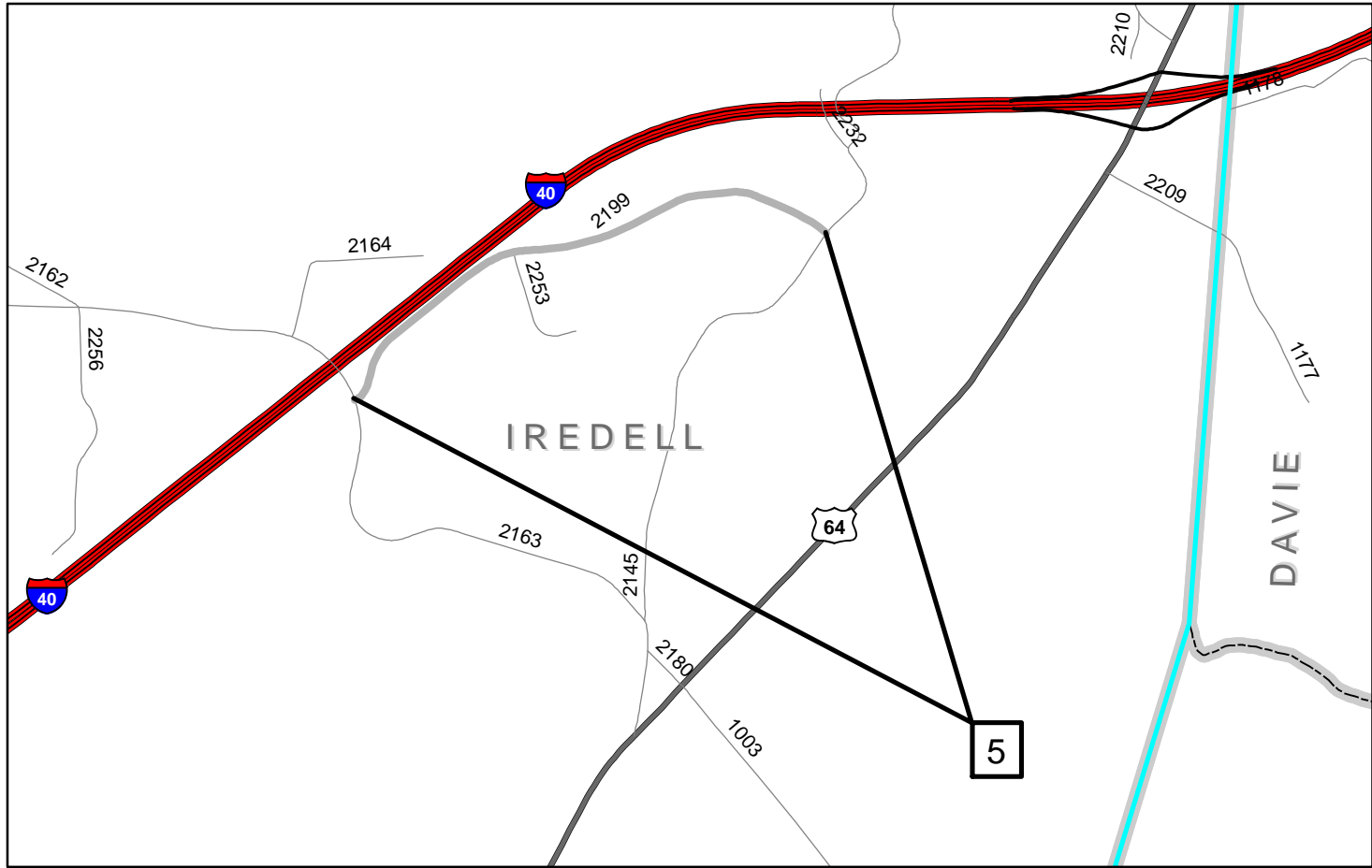
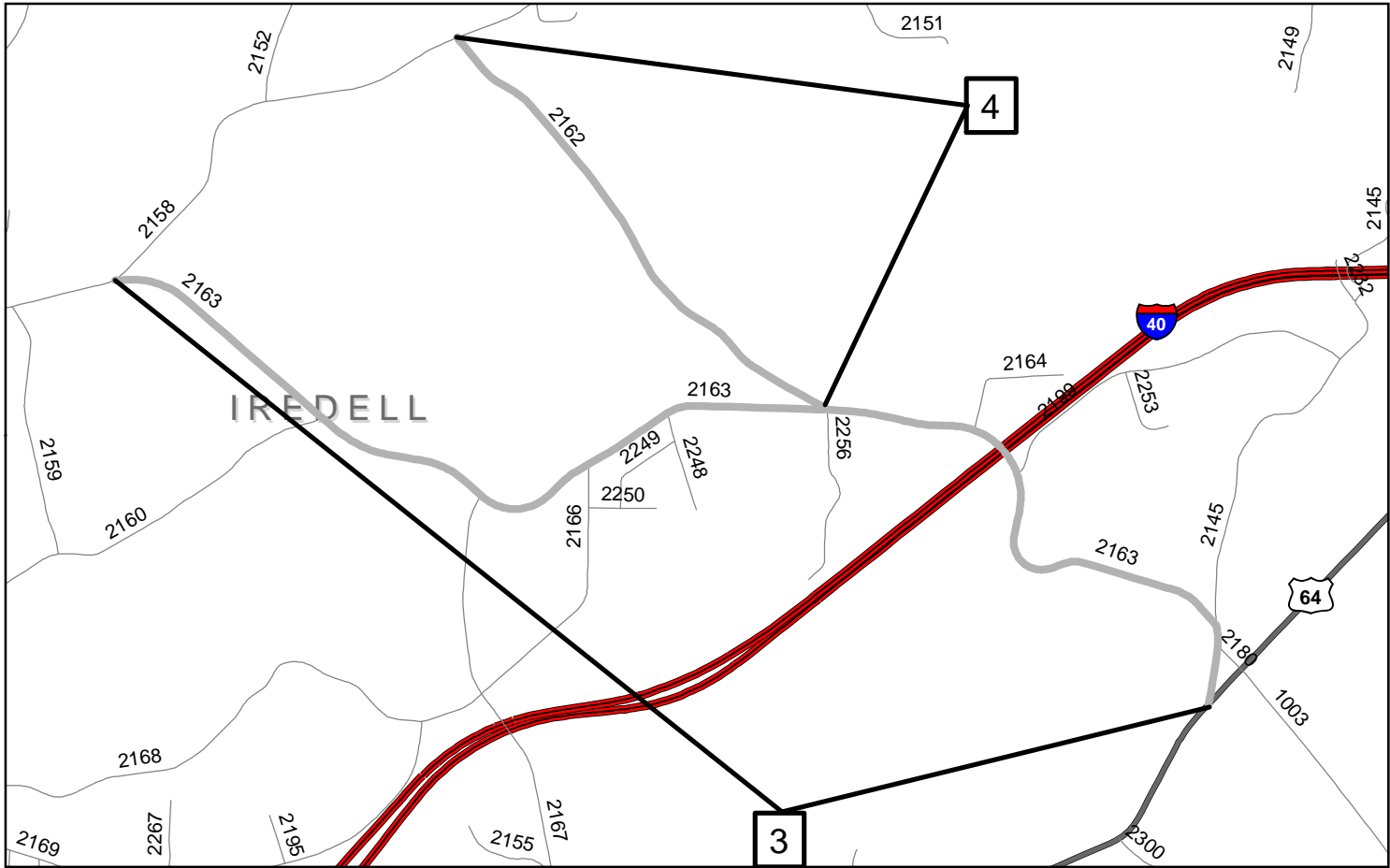

PAVEMENT SCHEDULE

STATE	PROJECT WBS	SHEET NUMBER
NC	2023CPT.12.07.20022	4
	2023CPT.12.07.20492	

F	ASPHALT SURFACE TREATMENT, DOUBLE SEAL, USING A TOP LIFT OF LIGHTWEIGHT AGGREGATE AND A BOTTOM LIFT OF 78M AGGREGATE.
G	ASPHALT SURFACE TREATMENT, FOG SEAL, WITH A TARGET APPLICATION RATE OF 0.12 GAL/SY, +/- 0.03 GAL/SY.

Checked by:
Drawn by: J. Barnette

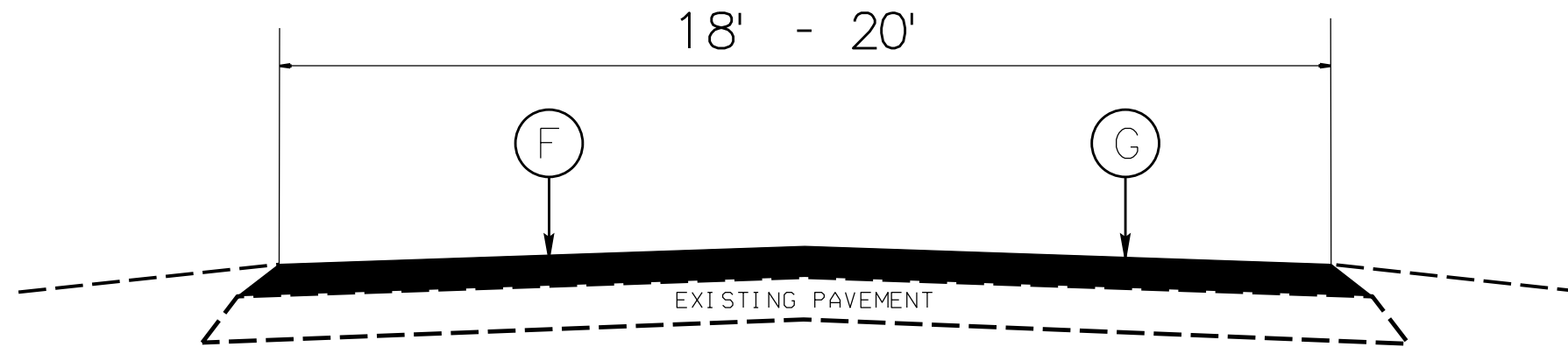

TYPICAL SECTION NO. 1

Typical Section
 Alexander & Iredell Co.
 2022-2023 Pvmt. Preservation

PROJECT NO.	SHEET NO.	TOTAL NO.
2023CPT.12.07.20022	5	
2023CPT.12.07.20492		

SUMMARY OF QUANTITIES

PROJECT NO	COUNTY	MAP NO	ROUTE	DESCRIPTION	TYP NO	LANES	LANE TYPE	FINAL SURFACE TESTING REQUIRED	WARM MIX ASPHALT REQUIRED	LENGTH	WIDTH	1803500000-E	1820000000-E	1838000000-E	2143000000-E	
												ASPHALT SURFACE TREATMENT, DOUBLE SEAL	ASPHALT SURFACE TREATMENT, FOG SEAL	EMULSION FOR ASPHALT SURFACE TREATMENT	BLOTTING SAND	
												MI	FT	SY	SY	GAL
2023CPT.12.07.20022	Alexander	1	SR 1403 (VASHTI RD.)	FROM NC 16 TO SR 1001 (SULPHUR SPRINGS RD.)	1	2		NO	NO	9.2	20	124,140	124,140	64,553	90	
2023CPT.12.07.20022	Alexander	2	SR 1431 (DANIELS RIDGE RD.)	FROM SR 1403 (VASHTI RD.) TO SR 1403 (VASHTI RD.)	1	2		NO	NO	1.89	20	25,505	25,505	13,263	15	
TOTAL FOR PROJ NO. 2023CPT.12.07.20022												11.09	149,645	149,645	77,816	105
2023CPT.12.07.20492	Iredell	3	SR 2163 (COOL SPRING RD.)	FROM US 64 TO SR 2158 (OLD MOCKSVILLE RD.)	1	2		NO	NO	4.53	19	58,075	58,075	30,199	45	
2023CPT.12.07.20492	Iredell	4	SR 2162 (WHITE OAK BRANCH RD.)	FROM SR 2158 (OLD MOCKSVILLE RD.) TO SR 2163 (COOL SPRING RD.)	1	2		NO	NO	1.71	19	21,885	21,885	11,381	15	
2023CPT.12.07.20492	Iredell	5	SR 2199 (LOGGERHEAD RD.)	FROM SR 2145 (GARDEN VALLEY RD.) TO SR 2163 (COOL SPRING RD.)	1	2		NO	NO	1.23	20	16,545	16,545	8,604	10	
2023CPT.12.07.20492	Iredell	6	SR 2145 (GARDEN VALLEY RD.)	FROM SR 2145 (SOCIETY RD.) TO SR 2163 (COOL SPRING RD.)	1	2		NO	NO	2.83	20	38,190	38,190	19,859	25	
2023CPT.12.07.20492	Iredell	7	SR 2180 (WOODLEAF RD.)	FROM US 64 TO SR 2163 (COOL SPRING RD.)	1	2		NO	NO	0.11	18	1,300	1,300	676	5	
2023CPT.12.07.20492	Iredell	8	SR 1003 (WOODLEAF RD.)	FROM US 64 TO ROWAN COUNTY LINE	1	2		NO	NO	1.19	19	15,245	15,245	7,928	15	
2023CPT.12.07.20492	Iredell	9	SR 2148 (BATTLE RD.)	FROM US 64 TO SR 2145 (GARDEN VALLEY RD.)	1	2		NO	NO	0.47	18	5,685	5,685	2,957	5	
TOTAL FOR PROJ NO. 2023CPT.12.07.20492												12.07	156,925	156,925	81,604	120
GRAND TOTAL												23.16	306,570	306,570	159,420	225

PROJECT NO.	SHEET NO.	TOTAL NO.
2023CPT.12.07.20022	6	
2023CPT.12.07.20492		

THERMOPLASTIC AND PAINT QUANTITIES

PROJECT NO	COUNTY	MAP NO	ROUTE	DESCRIPTION	TYP NO	LANES	LANE TYPE	LENGTH	WIDTH	4400000000-E	4457000000-N	4810000000-E	4810000000-E
								MI	FT	WORK ZONE ADVANCE/GENERAL WARNING SIGNING	TEMPORARY TRAFFIC CONTROL	4" WHITE PAINT	4" YELLOW PAINT
										SF	LS	LF	LF
2023CPT.12.07.20022	Alexander	1	SR 1403 (VASHTI RD.)	FROM NC 16 TO SR 1001 (SULPHUR SPRINGS RD.)	1	2		9.2	20	1,050	*	198,000	198,000
2023CPT.12.07.20022	Alexander	2	SR 1431 (DANIELS RIDGE RD.)	FROM SR 1403 (VASHTI RD.) TO SR 1403 (VASHTI RD.)	1	2		1.89	20	225	*	40,000	40,000
TOTAL FOR PROJ NO. 2023CPT.12.07.20022								11.09		1,275		238,000	238,000
2023CPT.12.07.20492	Iredell	3	SR 2163 (COOL SPRING RD.)	FROM US 64 TO SR 2158 (OLD MOCKSVILLE RD.)	1	2		4.53	19	525	*	95,675	95,675
2023CPT.12.07.20492	Iredell	4	SR 2162 (WHITE OAK BRANCH RD.)	FROM SR 2158 (OLD MOCKSVILLE RD.) TO SR 2163 (COOL SPRING RD.)	1	2		1.71	19	200	*	36,100	36,100
2023CPT.12.07.20492	Iredell	5	SR 2199 (LOGGERHEAD RD.)	FROM SR 2145 (GARDEN VALLEY RD.) TO SR 2163 (COOL SPRING RD.)	1	2		1.23	20	150	*	26,000	26,000
2023CPT.12.07.20492	Iredell	6	SR 2145 (GARDEN VALLEY RD.)	FROM SR 2145 (SOCIETY RD.) TO SR 2163 (COOL SPRING RD.)	1	2		2.83	20	325	*	60,000	60,000
2023CPT.12.07.20492	Iredell	7	SR 2180 (WOODLEAF RD.)	FROM US 64 TO SR 2163 (COOL SPRING RD.)	1	2		0.11	18	24	*	2,500	2,500
2023CPT.12.07.20492	Iredell	8	SR 1003 (WOODLEAF RD.)	FROM US 64 TO ROWAN COUNTY LINE	1	2		1.19	19	150	*	25,250	25,250
2023CPT.12.07.20492	Iredell	9	SR 2148 (BATTLE RD.)	FROM US 64 TO SR 2145 (GARDEN VALLEY RD.)	1	2		0.47	18	65	*		
TOTAL FOR PROJ NO. 2023CPT.12.07.20492								12.07		1,439		245,525	245,525
GRAND TOTAL								23.16		2,714	1	483,525	483,525

SIGNING FOR ASPHALT SURFACE TREATMENT

LEGEND

- ▷ PORTABLE SIGN
- └ STATIONARY SIGN
- ← DIRECTION OF TRAFFIC FLOW

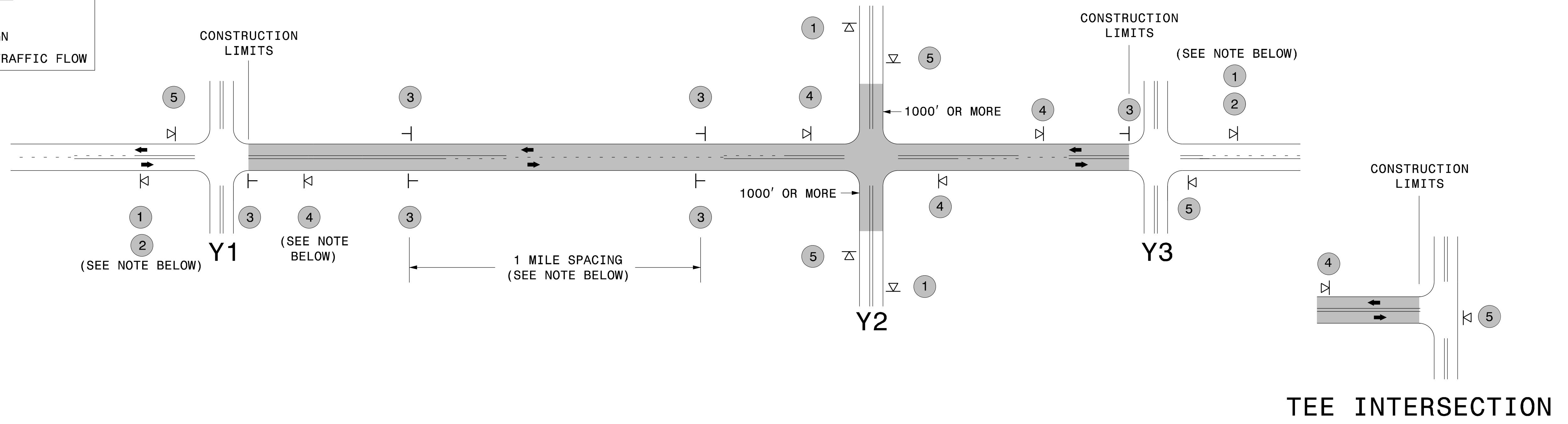

MAINLINE (-L-) SIGNING

-Y- LINE SIGNING

SIGNING NOTES AND PLACEMENT PER DIRECTION	<p>1</p> <p>W20-1 48" X 48"</p> <p>2</p> <p>W7-3qP 24" X 18"</p> <p>- PLACE 1000' PRIOR TO BEGINNING OF CONSTRUCTION LIMITS. ONLY USED ON -Y- LINES IF RESURFACING LIMITS EXTEND 1000' ALONG -Y- LINE.</p> <p>- SIGN #2 ONLY USED WHEN RESURFACING LIMITS ARE 2 OR MORE MILES IN LENGTH. ROUND UP TO THE NEAREST WHOLE NUMBER. DO NOT USE FRACTIONAL OR DECIMAL NUMBERS.</p>	<p>STATIONARY SIGNING NOT REQUIRED FOR THE FOLLOWING -Y- LINE CONDITIONS:</p> <ol style="list-style-type: none"> 1) LESS THAN 1000' OF RESURFACING ALONG -Y- LINE 2) SUBDIVISION ROADS 3) DEAD END ROADS <p>WHEN PAVING/CONSTRUCTION ACTIVITIES PROCEED ACROSS AN UNSIGNED -Y- LINE, PORTABLE ADVANCE WARNING SIGNS SHALL BE USED ALONG THE -Y- LINE AS SHOWN BELOW. REMOVE UPON COMPLETION OF WORK.</p> <div style="display: flex; justify-content: space-around;"> <div> <p>W20-1 48" X 48"</p> <p>PLACED 500' IN ADVANCE OF FLAGGER.</p> </div> <div> <p>W20-7 A 48" X 48"</p> <p>PLACED 250' IN ADVANCE OF FLAGGER.</p> </div> </div>
	<p>3</p> <p>W8-7 48" X 48"</p> <p>SP 48" X 48"</p> <p>- ALTERNATE THE FOLLOWING TWO SIGNS:</p> <p>- STARTING WITH "LOOSE GRAVEL" (W8-7) FOLLOWED BY "UNMARKED PAVEMENT".</p> <p>- PLACE INITIALLY AT THE CONSTRUCTION LIMITS AND SPACED 1 MILE APART THEREAFTER.</p> <p>- AT TEE INTERSECTIONS INSTALL INITIALLY 0.5 MILE FROM INTERSECTION AND SPACE 1 MILE APART THEREAFTER.</p>	
	<p>4</p> <p>SP 13106 48" X 48"</p> <p>- THESE ARE FOR -Y- LINES THAT ARE "THROUGH" ROADWAYS. DEAD END AND SUBDIVISION ROADS ARE NOT "THROUGH" ROADWAYS.</p> <p>- INSTALL 500' +/- FROM EACH -Y- LINE APPROACH AS SHOWN ABOVE.</p> <p>- FOR MULTIPLE -Y- LINES THAT ARE SEPARATED BY 0.25 MILES OR LESS, TREAT AS A SINGLE UNIT AND INSTALL WITHIN 500' OF EACH APPROACH.</p> <p>- A MAXIMUM OF 2 SIGN SETS PER MILE. DO NOT INSTALL WHEN -Y- LINES ARE WITHIN 0.5 MILES FROM "END ROAD WORK" SIGN.</p>	
	<p>5</p> <p>G20-2 A 48" X 24"</p> <p>PLACE 500' FOLLOWING THE END OF CONSTRUCTION LIMITS OR AS SHOWN WHEN WORK ENDS AT A 3-WAY TEE INTERSECTION.</p>	
	<p>THE ABOVE SIGNS ARE ALL THAT ARE REQUIRED FOR A CONTRACTOR TO BEGIN A RESURFACING CONTRACT. ANY ADDITIONAL SIGNS REQUESTED BY NCDOT DIVISIONS SHALL BE INSTALLED WITHIN 7 BUSINESS DAYS OF THE START OF CONTRACT WORK.</p>	

MAPS LESS THAN 2 MILES

FOR AST RESURFACING MAPS WITH CONSTRUCTION LIMITS LESS THAN 2 MILES IN LENGTH, USE A STATIONARY "LOOSE GRAVEL" SIGN AT THE BEGINNING CONSTRUCTION LIMIT FOLLOWED BY AN "UNMARKED PAVEMENT" SIGN MIDWAY THROUGH AND AN "END ROAD WORK" SIGN AT THE END CONSTRUCTION LIMIT.

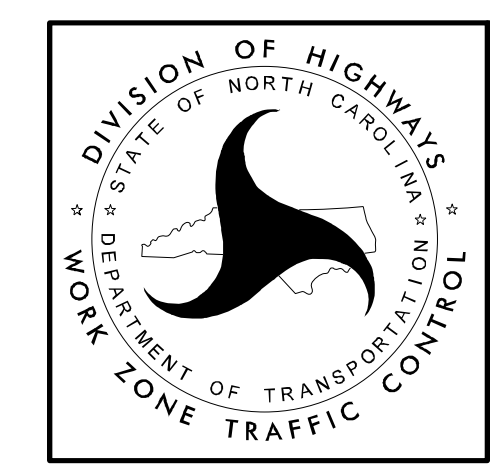

ADVANCE WARNING SIGNS FOR 2-LANE ROADWAY ASPHALT SURFACE TREATMENT